

TO: Board of Commissioners
FROM: Rob Sperl, Director of Parks & Planning
Steve Hinchee, Superintendent of Planning
THROUGH: Michael Benard, Executive Director
RE: Briar Patch Park Playground Safety Surface Replacement
DATE: April 19, 2023



SUMMARY:

As a part of the planned OSLAD Grant improvements for Briar Patch Park, the playground safety surfacing will be replaced. The playground currently has a bonded rubber mulch surface that provides excellent safety and accessibility but is beginning to show wear around high use zones.

The existing playground was installed in 2011, however the safety surfacing will not be effective for the approximately 20 year life span of the playground equipment.

Staff is continuing to recommend unitary surfacing for consistency of safety and accessibility. Our bid specifications are written to allow for a variety of surfacing types that will meet the current standards for fall protection and accessibility. The Base Bid includes the following: Remove and dispose of existing bonded rubber playground surfacing material. Install new playground surfacing material to meet Unitary Playground Safety Surfacing Material Specifications. The Alternate Bid includes: Remove bonded rubber surface in Oodle Swing area that failed testing and install new impact attenuation layer (approx. 350 SF). Level any low areas where existing surface has worn. Cover entire surface with artificial turf, poured-in-place rubber or other wear layer. Current lab tests were provided to bidders to demonstrate the surface specifications.

Plans and specifications were prepared by staff and sent to 21 contractors on March 14, 2023. Bids were opened on March 28, 2023. The results were as follows:

Contractor	Surface Type	Base Bid	Alternate #1
Perfect Turf LLC	Poured-in-Place Rubber	\$155,980.00	\$91,480.00

We talked to several of the bidders about why they did not submit proposals. Since we have an existing surface, there are cost savings to using the existing surface as a base layer. However, most manufacturers prefer to use only their systems which would not be cost competitive. We have had good experience with Perfect Turf and feel they can meet the outcome we are looking for.

Perfect Turf LLC is the lowest responsive bid for materials and installation and has successfully completed projects for the district in the past including the surfacing for the Kelly Park playground completed last year, as well as a similar recover at Northside Park playground in 2018.

PREVIOUS COMMITTEE/BOARD ACTION:

N/A

REVENUE OR FUNDING IMPLICATIONS:

\$630,000 is budgeted within the current fiscal year (40-800-806-57-5701-0000) for the OSLAD Grant improvements for Briar Patch Park. The grant project includes replacement playground safety surfacing, new pickleball courts, repaving tennis courts, baseball backstop replacements, outdoor fitness equipment, shelter and landscape improvements. The budgeted costs for the grant project are as follows:

Item – Briar Patch Park OSLAD Grant	Cost
Replace Tennis Courts/Fence	\$150,000
Pickleball Courts	\$100,000
Shelter Improvements	\$100,000
Backstop Replacement	\$85,000
Playground Safety Surfacing	\$80,000
Outdoor Fitness Equipment	\$75,000
Landscape Improvements	\$25,000
Engineering and Design	\$15,000
Total	\$630,000

STAKEHOLDER PROCESS:

N/A

LEGAL REVIEW:

Our legal counsel provided the front-end bid documents and sample legal agreement that will be used with the selected bidder.

ATTACHMENTS:

Briar Patch Park Unitary Playground Safety Surfacing Plan.

ALTERNATIVES:

See Summary section.

RECOMMENDATION:

It is recommended that the Wheaton Park District Board of Commissioners approve a contract for the provision and installation of the Briar Patch Park Playground Safety Surfacing - Alternate #1 from Perfect Turf LLC in the amount of \$91,480.00.



WHEATON PARK DISTRICT
 702 E WISLEY WHEATON, IL 60187
 (630) 685-4700

BRIAR PATCH PARK
UNITARY PLAYGROUND SAFETY SURFACING
 UNITARY SURFACING PLAN

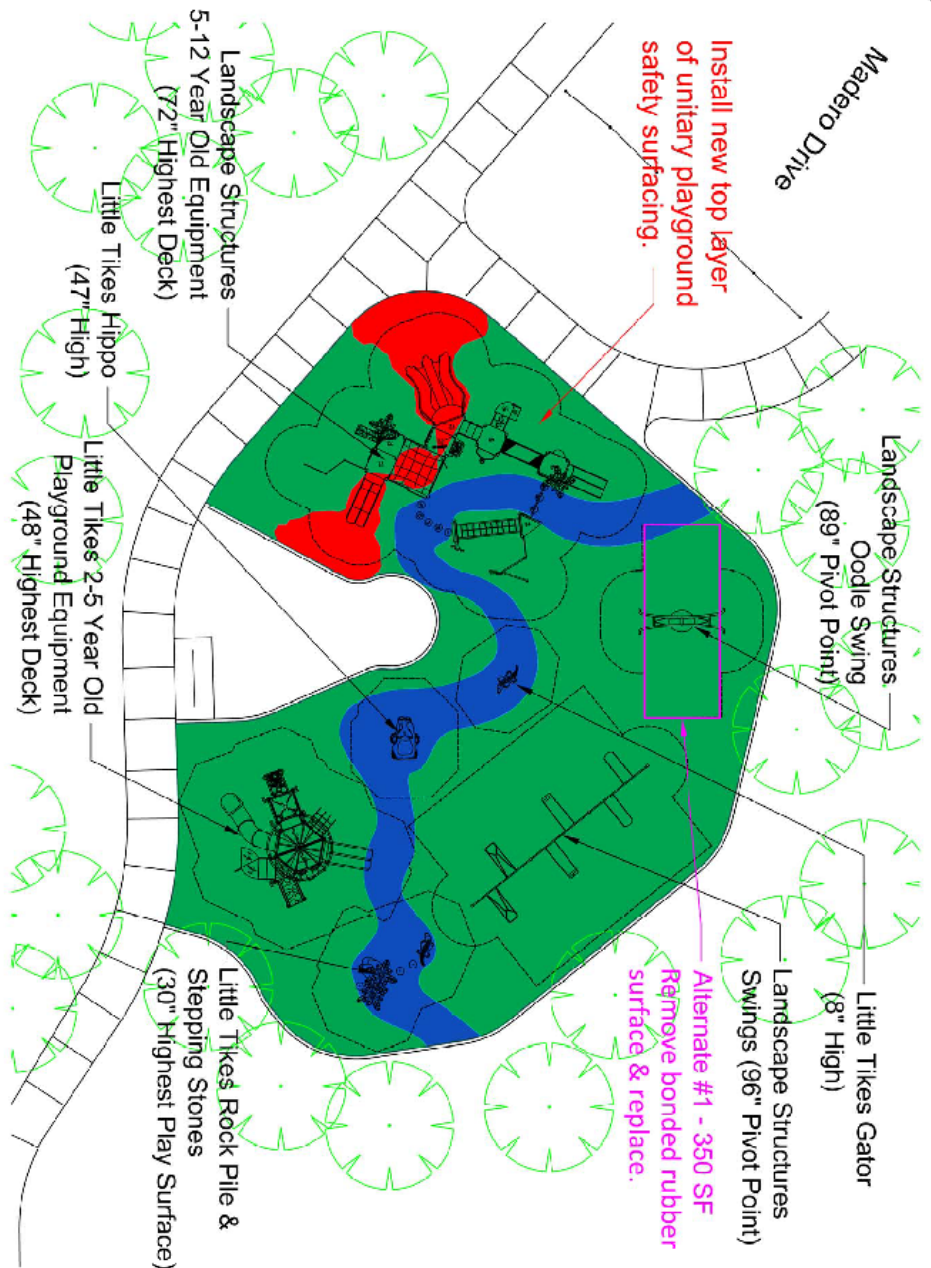

NOTES

1. ALL EQUIPMENT IS EXISTING.
2. ALL EQUIPMENT SHALL HAVE A UNITARY PLAYGROUND SAFETY SURFACE AS DEPICTED ON THE PLANS.
3. INSTALLATION SHALL CONFORM WITH CPSC, ASTM AND ADA GUIDELINES.
4. ALL PATHS ARE DRAWN WITH A RUNNING SLOPE LESS THAN 5% AND A CROSS SLOPE LESS THAN 2%.
5. COLOR TO BE SELECTED BY OWNER BASED ON MANUFACTURERS STANDARD COLORS.

Green "Grass" (selected from standard colors)	5,899 SF
Blue "River" (selected from standard colors)	1,081 SF
Red "Lava" (selected from standard colors)	493 SF
Total	7,230 SF



Drawn By:	MS
Checked By:	date: 3/9/23
Revised By:	date:
Revised By:	date:
Revised By:	date:
Revised By:	date:

Sheet 1 of 1